

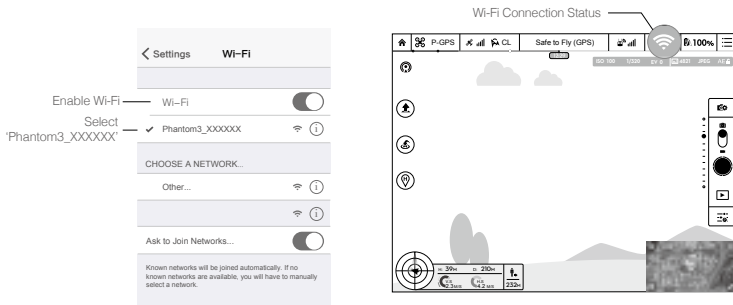

Connecting to the Wi-Fi Video Downlink:

1. Switch on the remote controller.
2. Turn on the aircraft.
3. On your mobile device, select 'Phantom3_XXXXXX' from the Wi-Fi network list, and enter the default password '12341234'.
4. Launch the DJI GO app and enter Camera View. A video signal from the aircraft's camera indicates that the aircraft has established a connection to the Wi-Fi video downlink successfully.



⚠ Once connected, you are advised to change the SSID and password by tapping  in Camera View.

Resetting the Wi-Fi Video Downlink

1. Power on the remote controller.
2. While holding down the C1 and C2 buttons on the back of the remote controller, press and hold the camera settings dial until you hear a beep.
3. Immediately toggle the flight mode switch. The status indicator will blink red and green alternately if resetting is in progress, and become solid green when it is complete.

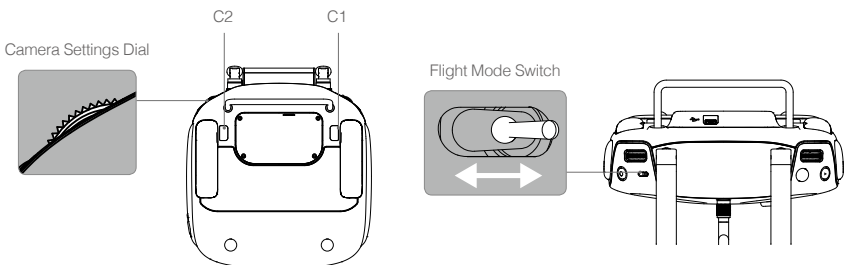

⚠ Toggle the flight mode switch to its original position after you finish resetting the Wi-Fi video downlink.